

# GEORGETOWN COMMUNITY PARK & GARDENS

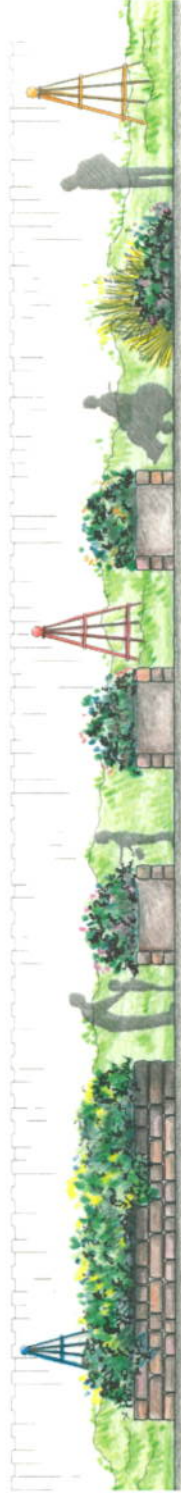

**PARK ENTRANCE // SECTION A - A // SCALE 1:75**

A strong sense of arrival is promoted through this extension of park space into the streetscape. Hardy garden beds with shrubs, and trees enhance the pedestrian experience, and add year-round interest, and aesthetic. This parkette also provides an opportunity for incorporating a focal sculpture feature, and murals along the court retaining wall.



**COMMUNITY GARDEN // SECTION C - C // SCALE 1:75**

This communal garden space provides an exciting opportunity for the community to get involved, volunteer and connect. This area could also showcase local sculpture, and could provide space for the future development of a year-round greenhouse, and public washrooms. Other features of this area include a secure shed, compost bins, rain barrels, secure potable water facet, drinking fountain and an asphalt games area.



**STORY NOOK // SECTION D - D // SCALE 1:75**

The garden beds, broad lush canopy, and logs for seating help to create a forest-like setting and make this a great spot to swap stories, share a picnic or simply relax. The large deciduous tree would be symbolic of the sycamore trees which were once iconic of the neighbourhood.



**LOOKOUT & PLAY GARDENS // SECTION B - B // SCALE 1:75**

With a view over the site, and paths winding up the hill, this feature would serve as an interactive natural play area. With the help of a little imagination, the log encircled lookout with large rounded boulder seating could transform into an eagle nest, or fortress for adventures, and fun.

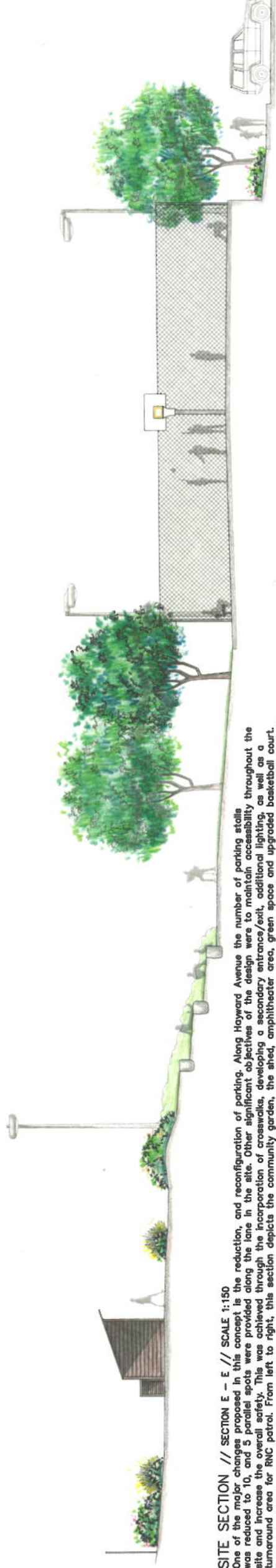

**SITE SECTION // SECTION E - E // SCALE 1:150**

One of the major changes proposed in this concept is the reduction, and reconfiguration of parking. Along Hayward Avenue the number of parking stalls was reduced to 10, and 5 parallel spots were provided along the lane in the site. Other significant objectives of the design were to maintain accessibility throughout the site and increase the overall safety. This was achieved through the incorporation of crosswalks, developing a secondary entrance/exit, additional lighting, as well as a turnaround area for RNC patrol. From left to right, this section depicts the community garden, the shed, amphitheater area, green space and upgraded basketball court. Recommended upgrades for the court include, new porous asphalt paving, new painted lines, professional size nets, a two meter run off (unobstructed space), timed lighting and seating.

RECEIVED  
DEPARTMENTS OF  
NOV 14 2012  
ENGINEERING  
AND PLANNING



GRAND  
CONCOURSE  
AUTHORITY

ST. JOHN'S

Georgetown  
Neighbourhood  
Association

GEORGETOWN  
COMMUNITY PARK & GARDENS  
CONCEPT THREE